



**MESA
ARTS
CENTER**

Dobson Lecture Hall

Mesa Arts Center

3/8/2021

Mesa Arts Center
Dobson Lecture Hall
1 East Main Street Mesa, AZ 85201

Table of Contents

General Information	3
Technical Services:	3
Programming:	3
Rental Contact:	3
Area Hotels.....	3
Management.....	4
Directions:.....	4
Load In Access:	4
Storage:	4
Dimensions and Seating.....	5
Room Dimensions	5
Room Drawing.....	5
Seating.....	5
Photographs.....	6
Audio	7
Lectern Audio	7
Laptop Audio	7
Other Gear (subject to availability).....	7
Lighting.....	7
Lighting Options	7
Video	7
Video Options	7

**Mesa Arts Center
Dobson Lecture Hall
1 East Main Street Mesa, AZ 85201**

General Information

Technical Services:

Director of Production

Robby Elliott

P: (480) 644-6597

E: Robby.Elliott@mesaartscenter.com

Production Supervisor /Primary Advancing Contact

Mike Johnson

P: (480) 644-6617

E: Mike.Johnson@mesaartscenter.com

Technical Director

Troy Buckey

P: (480) 644-6592

E: Troy.Buckey@mesaartscenter.com

Programming:

Director of Theater and Operations

Randy Vogel

P: (480) 644-6603

E: Randall.Vogel@mesaartscenter.com

Rental Contact:

Kim Forbes

P: (480) 644-6580

E: Kimberly.Forbes@mesaartscenter.com

Area Hotels

Delta Hotels Marriott

200 N Centennial Way

Mesa, AZ 85201

P: 480-898-8300

Baymont by Wyndham

651 E Main Street

Mesa, AZ 85203

P: 480-359-3698

Ramada by Wyndham

250 West Main Street

Mesa, AZ 85201

P: 480-834-9223

Holiday Inn & Suites

1600 S Country Club Dr

Mesa, AZ 85210

P: 480-964-7000

Mesa Arts Center Dobson Lecture Hall

1 East Main Street Mesa, AZ 85201

Management

Directions:

1. From Phoenix take Loop 202 East.
2. Exit Country Club Drive and head South to Main St.
3. Turn Left (East) on Main St. and travel a half mile until you come to Sirrine/Centennial Way
4. Turn Right (South) on Sirrine/Centennial Way
5. Take your first right into the service drive behind the Sunrise Bank. Follow the drive as it curves to the left.

Load In Access:

- The Dobson Lecture Hall is located on the basement level of the Mesa Contemporary Arts Museum, located at the Southeast corner of Main and Center.
- Load in access is either the curb cut on the service drive between 55 East Main and the Sunrise Bank, from the parking lot located at the Northeast corner of Center and 1st St, or a curb cut on Center between Main and 1st St.
 - Ask your rental coordinator for the appropriate load in location.
- Once vehicles are unloaded, they will need to be moved into a parking spot.
 - Ask your rental coordinator for the appropriate parking locations.
- If you need your vehicle closer to the lecture hall for load in or load out purposes, you must prearrange this with your rental contact.
- Absolutely no vehicles are allowed on the Shadow Walk (sidewalk in the middle of campus) without a security escort. Security can be reached at 480-644-6630.

Storage:

- Preshow or post-show storage is not available at the Mesa Arts Center. All items must arrive at your scheduled load in time and leave at load out. The Mesa Arts Center is not responsible for items left behind.

Mesa Arts Center
Dobson Lecture Hall
1 East Main Street Mesa, AZ 85201

Dimensions and Seating

Room Dimensions

- The Dobson Lecture Hall is 37' wide and 30'5" deep.

Room Drawing

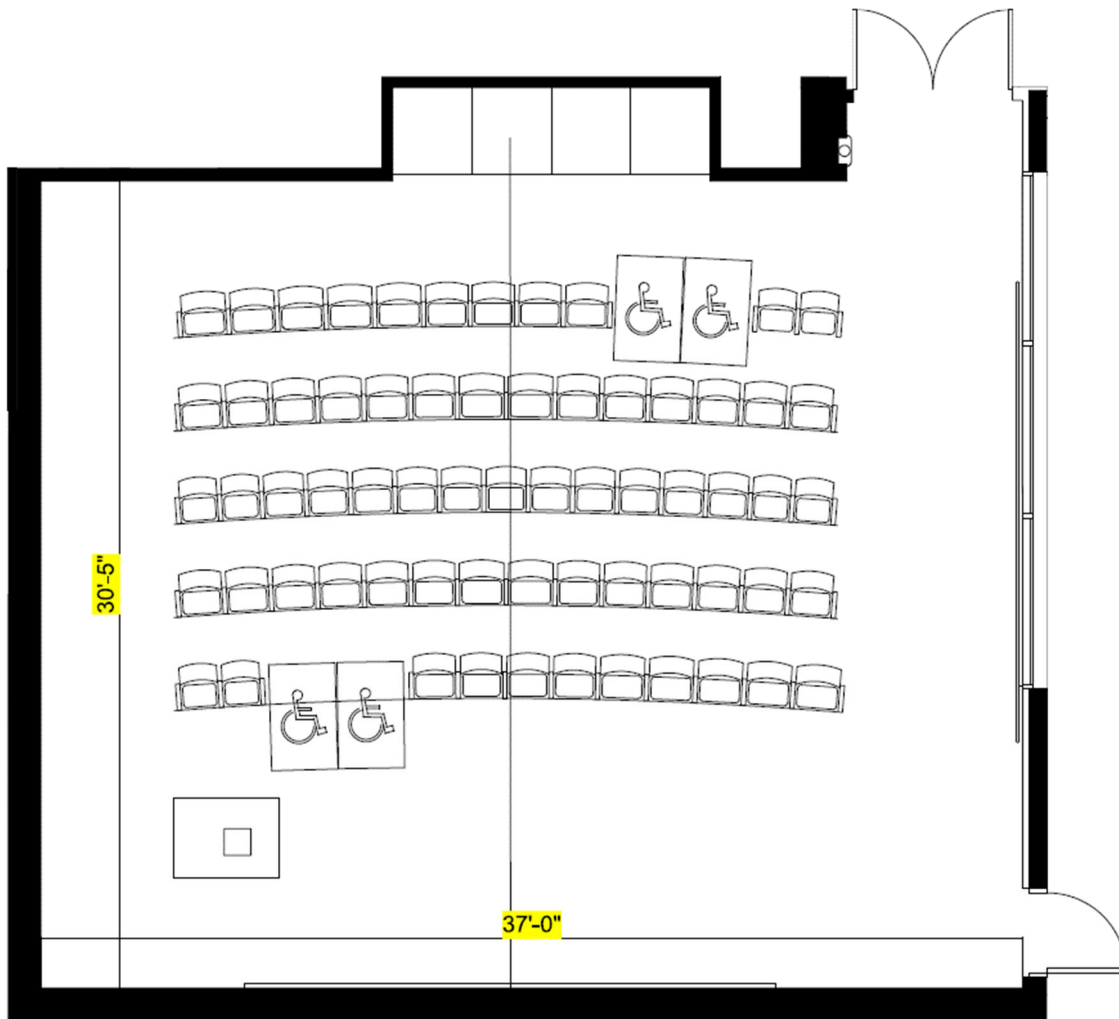

Seating

- The Dobson Lecture Hall has 65 fixed chairs and locations for up to 4 mobility devices.

Mesa Arts Center
Dobson Lecture Hall
1 East Main Street Mesa, AZ 85201

Photographs



This photograph is taken from the front center of the room. The podium is to the left of the photo.

Mesa Arts Center

Dobson Lecture Hall

1 East Main Street Mesa, AZ 85201

Audio

Lectern Audio

- There is a gooseneck microphone that is attached to the podium. This microphone is suitable for the Dobson Lecture Hall's size.

Laptop Audio

- There is an 1/8" connector and an HDMI connector on the podium. The audio system will work with either option.

Other Gear (subject to availability)

- Wireless microphones (lavaliers and handhelds) are available upon request.
 - The use of these may result in additional fees for labor and equipment.
 - The use of these microphones must be prearranged with your rental contact prior to your event.

Lighting

Lighting Options

- The lighting is dimmable and variable depending on the event's needs. The lighting can be controlled from a panel at the lecture hall's door.

Video

Video Options

- If a laptop is being used for the video portions, there is an HDMI connector and a VGA connector on the podium. The video system will work either of these options.
 - If the laptop the client is providing is a Mac, the client must supply an adapter to adapt from the Mac video port to either VGA or HDMI.
- If a DVD is being used, please provide your rental coordinator with the DVD.