



Nesbitt-Elliott Playhouse Theater Technical Information

Mesa Arts Center

12/1/2018

Mesa Arts Center
Nesbitt-Elliott Playhouse Theater Technical Information Packet

1 East Main Street, Mesa, AZ 85201
Technical Contacts: Phone: (480)644-6590 Fax: (480) 644-6594

Table of Contents

General Information 4
 Technical Services: 4
 Programming: 4
 Box Office: 4
 Area Hotels: 4
Management 5
 Green Room: 5
 Policies: 5
Load-In Area 5
 Load-In Access to Stage: 5
 Directions: 5
Carpentry 6
 Seating: 6
 Stage Dimensions: 6
 Stage Floor 6
 Non-Use Areas 6
 House Draperies (Goods): 8
 Line Set Data: 8
 House Line Set Plot: 9
 Support Areas: 10
Lighting 11
 Power: 11
 Control: 11
 Dimmers: 11
 Circuits: 11
 Circuit Locations: 12
 Equipment Inventory: 13
 House Lighting Plot Description 14
Audio 15

Mesa Arts Center
Nesbitt-Elliott Playhouse Theater Technical Information Packet

1 East Main Street, Mesa, AZ 85201
Technical Contacts: Phone: (480)644-6590 Fax: (480) 644-6594

Power: 15
Control Location:..... 15
Hearing Assist System: 15
Paging System: 15
Production Communication: 15
Equipment Inventory: 15
Video 17
 Projector: 17
 Projection Screen: 17
 Video Equipment: 17
Props 17
 Music: 17
 Platforms: 17
 Dance Floor: 17
 Lecturns: 17
Wardrobe 18
 Dressing Rooms: 18
 Wardrobe Area/Laundry Facility: 18

Mesa Arts Center
Nesbitt-Elliott Playhouse Theater Technical Information Packet

1 East Main Street, Mesa, AZ 85201
Technical Contacts: Phone: (480)644-6590 Fax: (480) 644-6594

General Information

Technical Services:

Director of Production
Robby Elliott
P: (480) 644-6597
E: Robby.Elliott@mesaartscenter.com

Production Supervisor /Primary Advancing Contact
Ashley Keen
P: (480) 644-6617
E: Ashley.keen@mesaartscenter.com

Technical Director
Troy Buckey
P: (480) 644-6592
E: Troy.Buckey@mesaartscenter.com

Programming:
Director of Theater and Operations
Randy Vogel
P: (480) 644-6603
E: Randall.vogel@mesaartscenter.com

Rental Contact:
Kim Forbes
P: (480) 644-6580
E: Kimberly.Forbes@mesaartscenter.com

Box Office:
Andrew Douglas
P: (480) 644-6507
E: Andrew.Douglas@mesaartscenter.com

Area Hotels:

Marriott Mesa
200 North Centennial Way
Mesa, AZ 85201
P: (480) 898-8300

Comfort Inn and Suites
651 East Main Street
Mesa, AZ 85201
P: (480) 621-6375

Best Western Mezona Inn
250 West Main Street
Mesa, AZ 85201
P: (480) 834-9233

Holiday Inn
1600 S Country Club Drive
Mesa, AZ 85210
P: (480) 863 - 4780

Mesa Arts Center

Nesbitt-Elliott Playhouse Theater Technical Information Packet

1 East Main Street, Mesa, AZ 85201

Technical Contacts: Phone: (480)644-6590 Fax: (480) 644-6594

Management

Green Room:

Green room is located center of the backstage hallway. There is a small patio off the green room that is shared with the Studio Theatre.

Policies:

- Lobby typically opens 1 hour prior to curtain with house opening 30 minutes prior to curtain.
- The Fire Curtain must not be obstructed in any manner which could prevent its complete contact with the stage floor when deployed.
- All scenery, drops, fabric and wood must be flame proofed. Random testing of articles will occur.
- As per the Fire Marshal, all doors in the facility are fire rated fire doors and must be able to close completely and form a tight, air-proof seal.

Load-In Area

Load-In Access to Stage:

- Two loading docks at stage level.
- Dock can accommodate 1 53' trailer (tractors have to detach), and 1 box truck simultaneously
- Driver must remain to move truck if necessary.
- Loading dock doors 10'W x 10'H
- Interior stage door is 8'11" W x 12' H
- Cargo must be ramped off or lifted off trucks. Loading Doors are at street level.
- There is no forklift on site
- Trucks and trailers must be moved to south surface lot
- Post-show storage is NOT available at the Mesa Arts Center. All items must leave at load-out. The Mesa Arts Center is not responsible for any items left behind.

Directions:

1. From Phoenix take Loop 202 East.
2. Exit Country Club Drive and head south to Main St.
3. Turn Left (East) on Main St. and travel a half mile until you come to Serrine/Centennial Way
4. Turn Right (South) on Serrine/Centennial Way
5. Take your first right into the service drive behind the Sunrise Bank. Follow the drive as it curves to the left. Park on the left, Performer entrance is on the right at the glass doors.

Mesa Arts Center

Nesbitt-Elliott Playhouse Theater Technical Information Packet

1 East Main Street, Mesa, AZ 85201

Technical Contacts: Phone: (480)644-6590 Fax: (480) 644-6594

Carpentry

Seating:

House Capacity – 200

Orchestra Section
176 Fixed
20 Loose Chairs
4 Wheelchair

Stage Dimensions:

Proscenium width: 30'

Proscenium height: 18'

SL Locking Rail to SR wall: 68'

Stage Left wing: 18'

Stage Right wing 20'

Plaster line to back wall: 31' 4"

Plaster line to last line set (37): 30'9"

Control Room to Plaster Line: 42'

House Mix Position to Plaster Line: 42'

Gridiron: 51'

Stage Floor

- 1" Maple Hardwood, painted black
- Lagging into MAC floors is allowed, but should all hardware must be Grade 5 or higher. Client will be responsible for all costs incurred to the MAC in the repair of the holes.
- No Traps are available

Non-Use Areas

- As per the Fire Marshall, floor areas blocked off in red floor paint must never be obstructed.

Mesa Arts Center Nesbitt-Elliott Playhouse Theater Technical Information Packet

1 East Main Street, Mesa, AZ 85201
Technical Contacts: Phone: (480)644-6590 Fax: (480) 644-6594

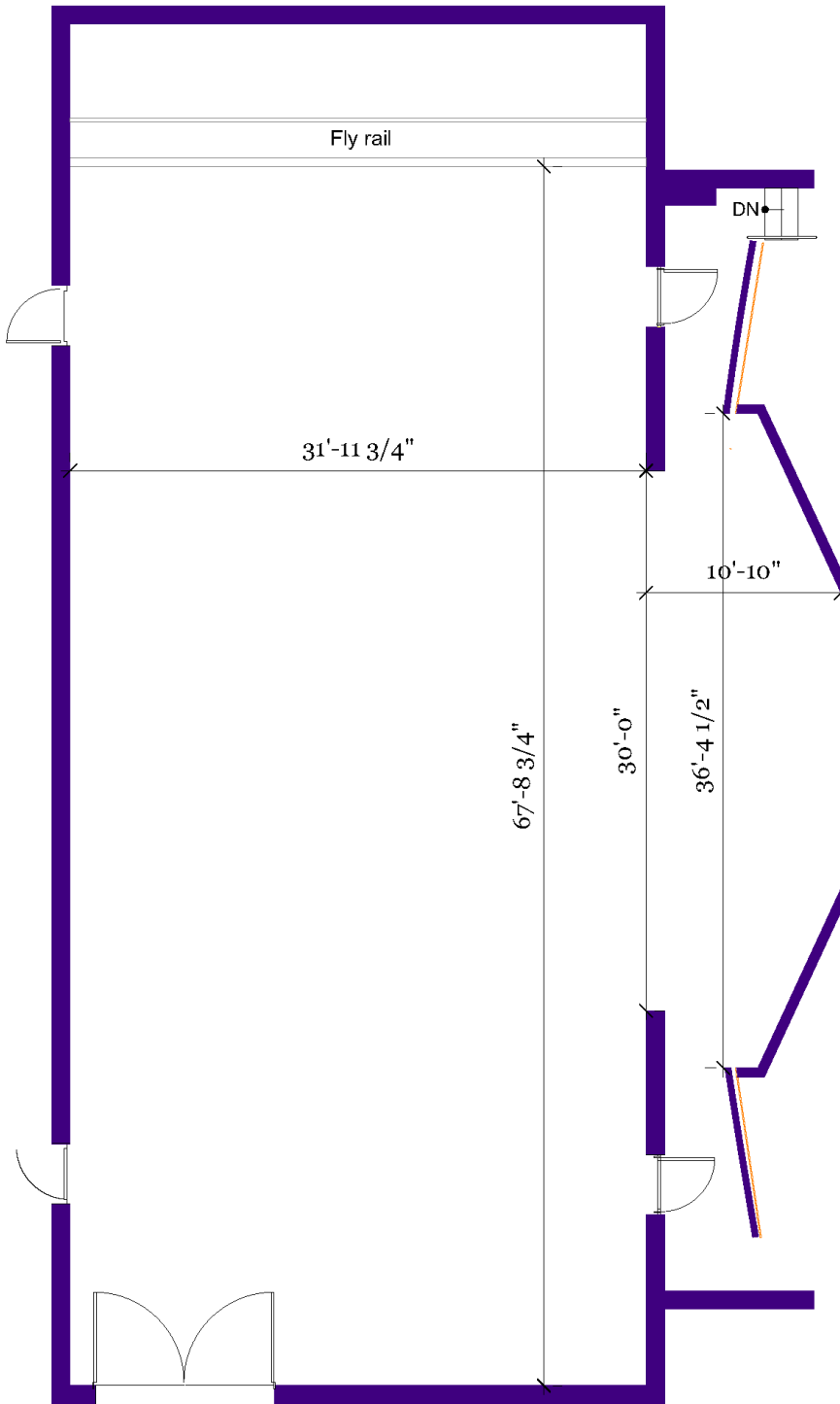

Mesa Arts Center

Nesbitt-Elliott Playhouse Theater Technical Information Packet

1 East Main Street, Mesa, AZ 85201

Technical Contacts: Phone: (480)644-6590 Fax: (480) 644-6594

House Draperies (Goods):

Draperies	Quantity	Size	Fullness	Fabric	Lining	Color	Notes
Main Border	1	44' x 8'	75% Sewn In	25 oz Velour	Black Ranger	Maroon	Nap Up
Main Drape	2	24' x 20'	75% Sewn In	25 oz Velour	Black Ranger	Maroon	Nap Up
Border	3	44' x 8'	None	22 oz Synth Velour	None	Black	Nap Down
Border	2	44' x 4'	None	25 oz Velour	None	Black	Nap Down
Leg	8	10' x 24'	None	22 oz Synth Velour	None	Black	Nap Down
Leg	2	9' x 20'	None	25 oz Velour	None	Black	Nap Down
Full Stage Black	2	24' x 24'	None	20 oz Velour	None	Black	Nap Down
Cyclorama	1	44' x 24'	None	Lino	None	White	Seamless
Black Scrim	1	44' x 24'	None	Sharktooth	None	Black	
Tabs	6	8' x 20'	None	25 oz Velour	None	Black	Nap Down
Z-Tech Border	35	10' 3'	None	Heat Stop	None	Black	Shared
Z-Tech Border	10	4' x 10'	None	Heat Stop	None	Black	Shared

Line Set Data:

Working Height of Battens:

- Linesets 1 through 11 High Trim: 42' 10"
- Linesets 12 through 37 High Trim 46' 9"
- Low Trim: 3'

Battens: 37 Battens, 44' Long, Schedule 40

Type: Single Purchase

Arbor Capacity: Varies.

Available Weight: Located Stage Left Mid-Rail and Stage Left Loading Rail

Loading Galleries: 2 Located Stage Left at 27' and 47' above stage floor

Pin Rail: Located Stage Left at 3' 6"

Side Ladders: There are 4 sets of ladders that are on tracks on either side of stage. 24' from center line. These ladders do fly.

Side Tab Curtains: There are 6 side curtains, 3 on each side. 26' from center line. These side tabs do fly.

Mesa Arts Center

Nesbitt-Elliott Playhouse Theater Technical Information Packet

1 East Main Street, Mesa, AZ 85201

Technical Contacts: Phone: (480)644-6590 Fax: (480) 644-6594

House Line Set Plot:

LINE SET	FROM PROSC.	DESCRIPTION
SLT	0'6"	STAGE LEFT TABS
MT	1'	MAIN TEASER
1	1' 6"	DO NOT USE, Hangs Up on Drapes
MD	2'	MAIN DRAPE
2	2' 6"	DO NOT USE, Hangs Up on Drapes
3	3'	LEGS
4	3' 6"	
5	4'	1st Electric
6	4' 6"	
7	5'	RP SCREEN
8	5' 6"	
9	6'	
10	6' 6"	
11	7'	
SLL	8' 3"	STAGE LEFT LADDERS
12	9'	
13	9' 9"	BORDER
14	10' 6"	LEGS
15	11' 3"	2nd Electric
16	12'	
17	12' 9"	
18	13' 6"	
SRL	14' 3"	STAGE RIGHT LADDERS
19	15' 9"	
20	16' 6"	Full Stage Black (2 panels)
21	17' 3"	
22	18'	BORDER
23	18' 9"	LEGS
24	19' 6"	3rd Electric
25	20' 3"	
26	21'	
SRT	21' 9"	STAGE RIGHT TAB BATTEN
27	23' 3"	BORDER
28	24'	LEGS
29	24' 9"	BLACK SCRIM
30	25' 6"	
31	26' 3"	4 th Electric
32	27'	
33	27' 9"	
34	28' 6"	
35	29' 3"	BORDER + SPARE
36	30'	LEGS
37	30' 9"	CYCLORAMA

Mesa Arts Center

Nesbitt-Elliott Playhouse Theater Technical Information Packet

1 East Main Street, Mesa, AZ 85201

Technical Contacts: Phone: (480)644-6590 Fax: (480) 644-6594

Support Areas:

Crossover:

There is no dedicated crossover onstage. Closest crossover is the Upstage Hallway with Access to Stage Right and Stage Left

Access:

From Front of House: Hallway Stage Right to Upstage Hallway

From Dressing Rooms: Dressing Rooms are located on the 2nd floor Upstage Hallway, accessible via stairway in the Upstage Left Hallway.

Storage:

There is no dedicated storage space for events. Events may store equipment in loading dock and in purple painted areas in the Ikeda hallway during their stay. Storage is not available before or after the show. All items must leave at load-out.

Mesa Arts Center

Nesbitt-Elliott Playhouse Theater Technical Information Packet

1 East Main Street, Mesa, AZ 85201

Technical Contacts: Phone: (480)644-6590 Fax: (480) 644-6594

Lighting

Power:

Quantity	Voltage	Phase	Amperage	Location	Connection
1	120/208	3 Phase	400a	Stage Right Wall	Cam
2	120/208	3 Phase	200a	Stage Right Wall	Cam

Control:

- ETC Element
- 500 Channel Capability
- 1024 Outputs
- 60 Submasters

Dimmers:

- 178 ETC Sensor Dimmers, 2.4kW dimmer
- 24 ETC Sensor Dimmers, 2.4 kW dimmer (Starting Address 226)
- 24 ETC SmartBar Dimmers, 1.2 kW dimmer (Starting Address 250)
- 1 ETC Sensor Dimmers, 6kw dimmer

Circuits:

- 178 - 2.4kw circuits. Fixed Positions on Stage Right and Stage Left catwalks with socopex multicable connections. See Attachment for specific locations
- 24 – 2.4kw circuits. Provides 12 circuits to S.L. Ladders, and 12 circuits to S.R. Ladders via socopex.
- There is no front of house transfer

Mesa Arts Center

Nesbitt-Elliott Playhouse Theater Technical Information Packet

1 East Main Street, Mesa, AZ 85201

Technical Contacts: Phone: (480)644-6590 Fax: (480) 644-6594

Circuit Locations:

Location	Dimmers	House Plot Location
FOH Catwalk	1 – 21	FOH Catwalk, 21 on Proscenium Elec
House Right Catwalk	22 – 27	House Right Catwalk
House Left Catwalk	28 – 33	House Left Catwalk
Above Proscenium Dead Hung	34 – 45	Above Proscenium Dead Hung
Grid (Up Stage Center)	52	Grid (Up Stage Center)
Stage Left Gallery	53 – 88 6 Soco Connections	2 nd and 4 th Electrics
Stage Right Gallery	89 – 130 7 Soco Connections	1 st and 3 rd Electrics
Stage Right Gallery	250-273 24 ch. Dimmer rack	SL and SR Ladders
Down Stage Right Wall (Stage level)	140, 141	Down Stage Right Wall (Stage level)
Down Stage Left Wall (Stage level)	142, 143	Down Stage Left Wall (Stage level)
Up Stage Right Wall (Stage level)	177	Up Stage Right Wall (Stage level)
Up Stage Left Wall (Stage level)	178	Up Stage Left Wall (Stage level)
Stage Right Floor (Floor Pockets)	144 – 152	Stage Right Floor (Floor Pockets)
Stage Left Floor (Floor Pockets)	153 – 161	Stage Left Floor (Floor Pockets)
Up Stage Floor (Floor Pockets)	162 – 176	Up Stage Floor (Floor Pockets)
Down Stage Floor (Floor Pockets)	131 – 139	Down Stage Floor (Floor Pockets)
House Right Torm (in Proscenium)	46 – 48	HR Torm, 46 on Proscenium Elec
House Left Torm (in Proscenium)	49 – 51	HL Torm, 49 on Proscenium Elec
House Lights	182 – 192	House Lights

Mesa Arts Center

Nesbitt-Elliott Playhouse Theater Technical Information Packet

1 East Main Street, Mesa, AZ 85201

Technical Contacts: Phone: (480)644-6590 Fax: (480) 644-6594

Equipment Inventory:

Stage Instrument Inventory:

Quantity	Brand	Type	Wattage
20	ETC Source 4	19 Degree	575wt
10	ETC Source 4	26 Degree	575wt
72	ETC Source 4	36 Degree	575wt
40	ETC Source 4	50 Degree	575wt
48	ETC Fresnel	7" Fresnel	575wt
6	L&E	3 Cell Cyc	1kw
5	Ground Strip	6 Cell	1kw
1	ETC S4 Followspot in booth with manual dimmer, iris, and ball bearing collar	19 Degree	575W

Stage Instrument Accessories:

Quantity	Item
142	Source 4 Gel Frame
30	Source 4 Fresnel Gel Frame
60	Source 4 Size B Gobo Holder
1	Portable DMX Output Node
12	Floor Bases for Stage Instruments
8	12' Schedule 40 Boom Pipes with Floor Bases

Cable Inventory: (NOTE: Most of the multi-pin cable is in use as part of the house lighting plot)

Quantity	Item
20	5' 12/3 Stage Pin Power Cable
30	10' 12/3 Stage Pin Power Cable
20	20' 12/3 Stage Pin Power Cable
30	Stage Pin Two-Fer
15	15' 6-Circuit Multi-Pin Power Cable
12	30' 6-Circuit Multi-Pin Power Cable
17	100' 6-Circuit Multi-Pin Power Cable
4	6-Circuit Multi-Pin Power Cable Stage Pin Break In
22	15' 6-Circuit Multi-Pin Power Cable Stage Pin Break Out
20	25' 14/3 Edison Power Cable
20	50' 14/3 Edison Power Cable
10	Power Strip
10	Tri Tap

Mesa Arts Center

Nesbitt-Elliott Playhouse Theater Technical Information Packet

1 East Main Street, Mesa, AZ 85201

Technical Contacts: Phone: (480)644-6590 Fax: (480) 644-6594

House Lighting Plot Description

- The Playhouse Theater house lighting plot is capable of up to 4 different top color washes on stage.
- A two-color high side wash is available from the 1st, 2nd, and 3rd over stage (S4's)
- 3 fixtures are also available on each electric for overhead specials
- 2 separate washes are possible from FOH using 20 Source Four 19 degree fixtures.
- High Sides from FOH also available.
- Up to 3 color Cyclorama wash (red, green, blue or amber) is also available
- Please speak to the MAC Assistant Technical Director to request a plot or for more information
- Lighting ladders have 12 S4 36 degree each side of stage with single circuits from separate dimmer rack located on the Stage Right Mid-rail
- **NOTE: Not all fixtures may be available because they are being used on house plot**

Extra equipment available (Subject to availability)

- 4 High End Systems AF1000 Dataflash Strobe.
- 2 Atomic 3000 Strobe.
- Ultratec FX Radiance Haze Generator (Mounted on S.R. Midrail with a fan)
- Rosco 1700 Smoke Generator.
- Ultratec LSG PFI-9D Low Fog Generator (additional equipment needed from outside vendor)

Mesa Arts Center

Nesbitt-Elliott Playhouse Theater Technical Information Packet

1 East Main Street, Mesa, AZ 85201
Technical Contacts: Phone: (480)644-6590 Fax: (480) 644-6594

Audio

Power:

Quantity	Voltage	Phase	Amperage	Location	Connection
1	120/208	3 Phase	400a	Stage Right Wall	Cam
2	120/208	3 Phase	200a	Stage Right Wall	Cam

Control Location:

Located center in the control booth. Windows can be opened. Approximately 40' from plaster line.

Hearing Assist System:

Infrared hearing assist system is available to patrons via the house management staff.

Paging System:

Paging System to the US Hallway, Upstairs Dressing Room Hallway and Dressing Rooms. Paging locations are located DSR, DSL and in the Lighting Control Booth.

Video Feed of the stage can be fed to DSL, DSR, USR, Control booth, and Greenroom.

Production Communication:

2 Channel Clear-Com Production Communication System

- 8 single channel Clear-Com RS701 beltpacks
- 1 Clear-Com KB-502 Speaker Station
- 9 Single Ear Clear-Com Headsets

Equipment Inventory:

Front of House Mixing Consoles:

- Behringer X32

Processing Gear:

- 1 DBX 2231 Graphic Eq/Limiter (Patched to booth monitors)
- 1 Tascam MD-CD1 CD Player/Mini Disc Player (independent playback, and auto pause feature)
- 1 Denon CDR-W1500CD Player/ CD-R dual deck. (combined output, no auto pause feature)
- 1 Furman PL-plus Series Power conditioner

Speaker System: Tannoy P.A. package

- 2 Tannoy V15 Full range cabinets (1 per side)
- 2 Crown Macro-Tech 1202 amps. (1 channel to each V15, 1 spare amp for passive monitors)
- 2 Tannoy B475 Subwoofers (1 per side, parallel off of an aux send)
- 1 Crown Macro-Tech 2402 amp. (1 channel to each sub)

Mesa Arts Center

Nesbitt-Elliott Playhouse Theater Technical Information Packet

1 East Main Street, Mesa, AZ 85201

Technical Contacts: Phone: (480)644-6590 Fax: (480) 644-6594

- 2 Channels of Monitor Amplification
- 2 Yamaha CM-15V Stage Monitors
- 2 Renkus Heinz SR8 Stage Monitors

Microphones:

#	Make/Model	Type
4	Shure SM 58	Dynamic Cardioid Vocal
4	Shure SM 57	Dynamic Cardioid Instrument
4	Sennheiser E-614	Condenser Cardioid Instrumental
1	AKG D112	Dynamic Cardioid
4	Crown PCC 160	Condenser Unidirectional Boundary
2	Audio Technica U853R	Condenser Cardioid Choir mic
8	DOD 265	Direct input box
1	PG-48	Dynamic Cardioid Vocal Switched

Cable:

Quantity	Item
20	10' XLR
40	25' XLR
6	50' XLR
2	100' XLR
4	12 channel XLR Snake
2	LTI Laptop Audio Interface
2	Male XLR to TT
2	Female XLR to TT
4	25' NL2 (for passive monitors)
4	50' NL2 (for passive monitors)

Mesa Arts Center

Nesbitt-Elliott Playhouse Theater Technical Information Packet

1 East Main Street, Mesa, AZ 85201

Technical Contacts: Phone: (480)644-6590 Fax: (480) 644-6594

Video

Projector:

- Panasonic PT-VZ570, 4,800 lumen WUXGA Projector
 - Inputs: HDMI, VGA

Projection Screen:

- 120" H x 90" W 4:3 DaLite Rear Projection Screen. Screen is hung from Flyrail and typically lives at 5' Upstage of Proscenium Line

Video Equipment:

- Roland V-1HD Video Switcher
 - 4 HDMI Inputs
 - HDMI Output (selectable 1080p, 1080i, 720p)
 - HDMI Preview Out

Props

Music: (shared throughout facility, subject to availability)

Chairs: 200 Wenger Padded Black Chairs

Music Stands: 200 Wenger Music Stands

Stand Lights: 200 Stand Lights

Conductor Podium: Wenger 2 Step Podium with Conductor Music Stand

Platforms: (shared throughout facility, subject to availability)

24 Wenger 4'x8' platforms

8 Wenger 4'x4' platforms

Legs to raise platforms to 8", 16", 24" and 32" heights

Dance Floor:

6 sections of Rosco Dance Floor: 5'3" x 40'

1 section of Rosco Dance Floor: 5'3" x 30' (Proscenium)

Lecturns: (shared throughout facility, subject to availability)

2 Dalite Black Podiums

Mesa Arts Center
Nesbitt-Elliott Playhouse Theater Technical Information Packet

1 East Main Street, Mesa, AZ 85201
Technical Contacts: Phone: (480)644-6590 Fax: (480) 644-6594

Wardrobe

Dressing Rooms:

- 2 Chorus Dressing Rooms (12-person capacity comfortably) with 3 showers and 3 Toilet stalls. Located in Up-Stage 2nd Floor Hallway
- 2 Rolling wardrobe racks in each dressing room
- 1 Rolling wardrobe rack in greenroom

Wardrobe Area/Laundry Facility: (shared throughout facility, subject to availability)

- Main laundry facility is located on the 2nd floor. This is shared between all theaters at the Mesa Arts Center and is subject to availability.
- 1 clothes rack is in each dressing room. 6 more racks may be available in wardrobe room (based on availability)
- 3 iron and 3 ironing boards (based on availability)
- 6 steamers (based on availability)
- 2 Whirlpool washing machines (based on availability)
- 2 Whirlpool dryers (based on availability)